

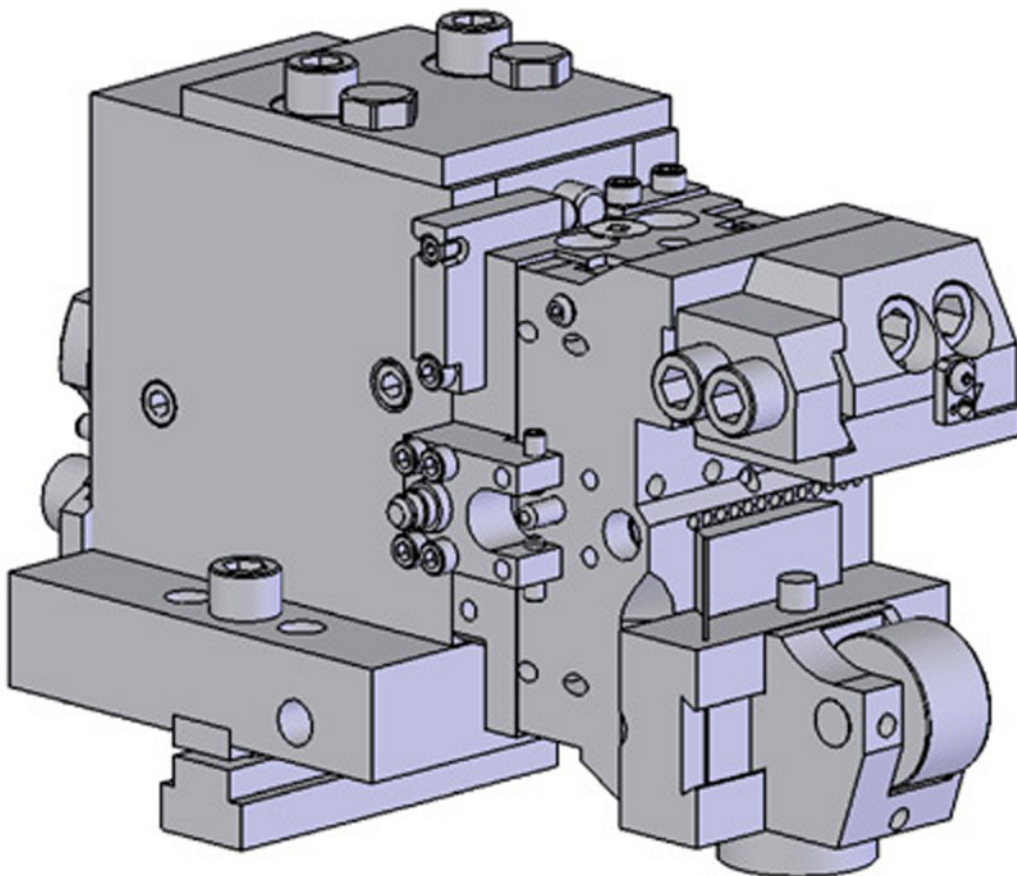

New Market Products, LLC

V7 Shave Holder Instruction Book



**P.O. Box 135
Wayne, NY 14893
www.nmpco.com**

**Phone: 800-238-2240
Fax: 607-292-6858
Email: nmpco@nmpco.com**

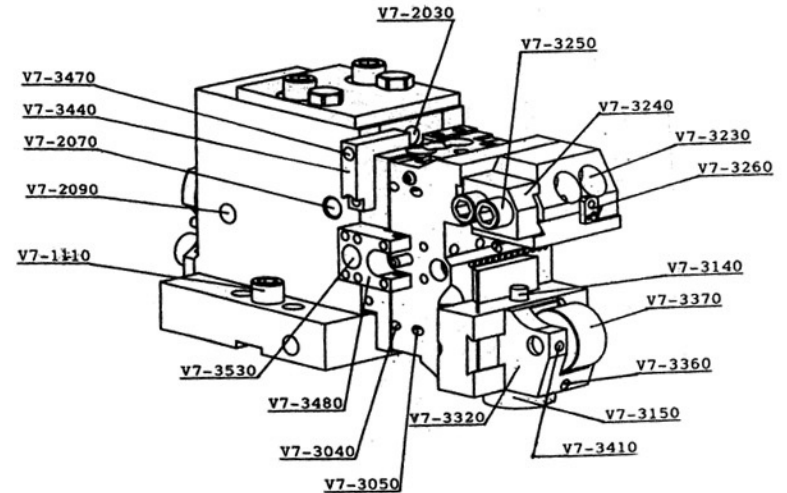
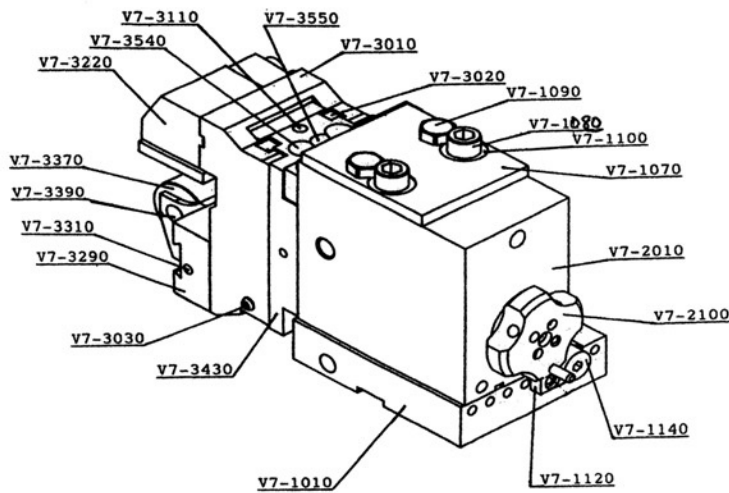

Installing the Shave Holder on Your Machine

1. Loosen the (2) main bolts (V7-1080) and the side lock screw (V7-1110).
2. Slide the T-nut into the T-slot to the desired position. Side adjusting screw and plate are available if desired.
3. Tighten the main bolts and the side lock screw.

Installing and Removing the Shave Head

To Install

1. Thread head mounting bolt (V7-2100) into the head. Tighten until snug.
2. Tighten taper lock screw (V7-2070).
3. Tighten head mounting bolt 1/4 turn. **DO NOT OVER TIGHTEN!!**

To Remove

1. Loosen taper lock screw (V7-2070).
2. Unthread head mounting bolt (V7-2100) from head while supporting head.

Adjusting the Depth Position

1. Loosen the (2) main bolts (V7-1080) and the (2) depth lock screws (V7-1090).
2. Adjust the rear adjusting screw (V7-1140) to the desired position. Each division equals 0.010".
3. Tighten the main bolts and the depth lock screws.

To Adjust Taper

1. Loosen the taper lock screw (V7-2070).
2. Loosen the head mounting bolt (V7-2100) 1/4 turn.
3. Adjust the taper adjusting screw (V7-3470) to the desired position.
4. Tighten the taper lock screw
5. Tighten head mounting bolt.

To Adjust Spring Tension

1. Adjust the travel spring screw (V7-3110) to the desired tension. This screw can be accessed at both ends: one end with a flat screwdriver and the other end with a 1/8" hex key.

To Adjust Travel Stops

1. Adjust the travel stop screws in the travel stop plate (V7-3480) to the desired position.

To Adjust Gibs

1. Adjust the (4) gib adjustment screws (V7-3040). These should be adjusted as tight as you can while still sliding the head with no spring pressure.

Maintenance

This shave holder should be greased daily with an NGLI# 0 grease, preferable Dow Corning G-0050 FM. This will improve performance and decrease wear.